

GENERAL INSTRUCTIONS FOR CERAMIC DISC CARTRIDGE REPLACEMENT

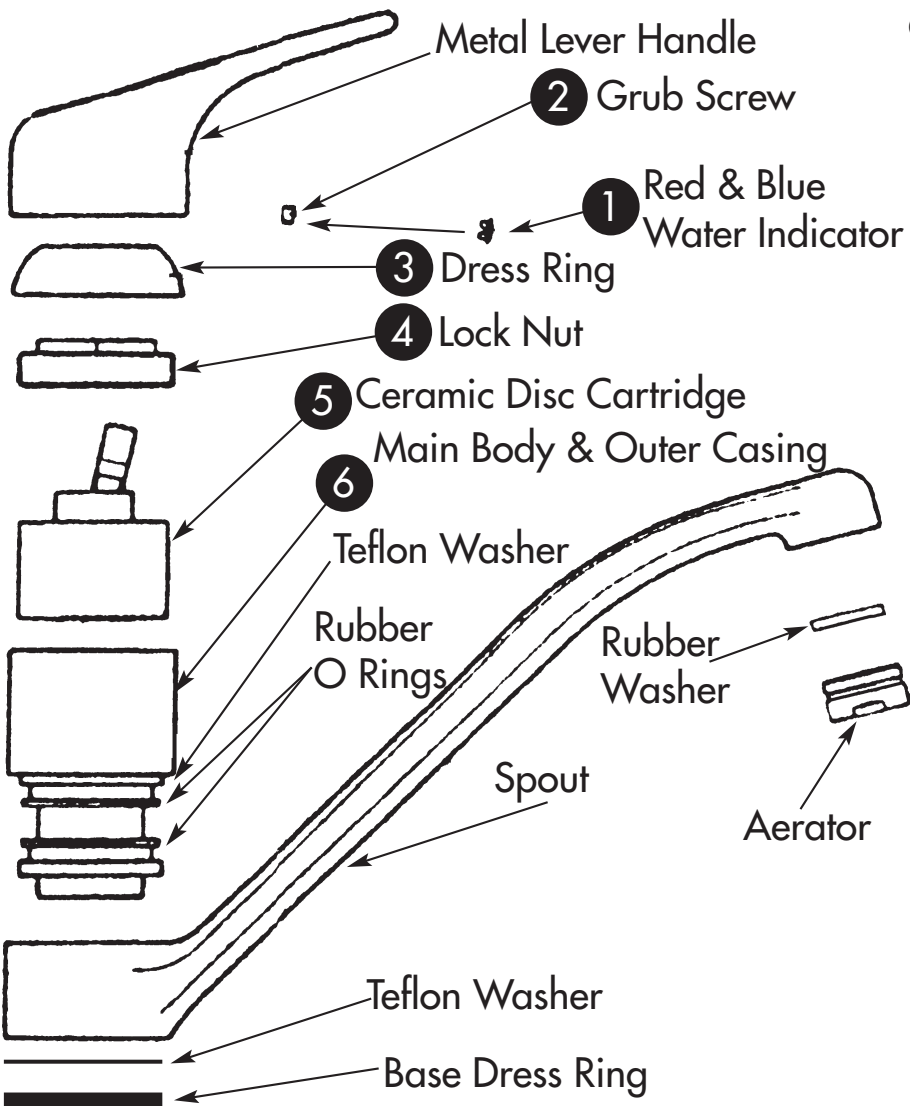

Project sink mixer is illustrated

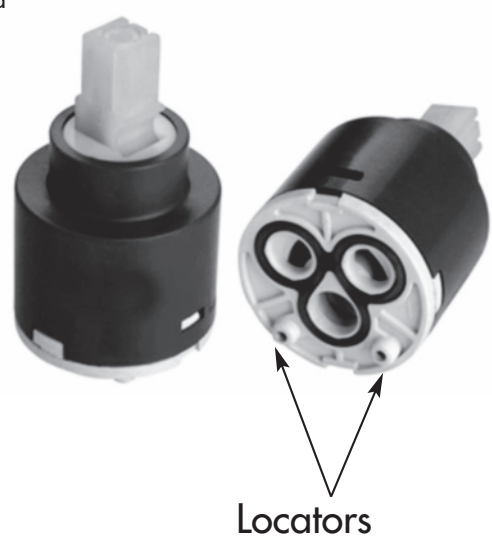

NOTE: Please turn off water supply at the stop taps or water meter.

1. To replace the cartridge, follow the step by step instructions. Remove the blue/red indicator (1).
2. Insert the allen key supplied into the grub screw (2) and turn it anti-clockwise. Once the screw is loose, the handle can then be pulled in the up-ward direction.
3. Remove the chrome Dress Ring (3) by hand in the anti-clockwise direction.
4. Use an appropriate spanner to undo the brass lock nut (4) in the anti-clockwise direction.
5. Pull the square post upwards to remove the cartridge (5).
6. Use a dry cloth to dry up any water inside the tap body (6)
7. Insert the new cartridge making sure the two locators at the bottom of the cartridge seat inside the tap body (6)
8. Replace brass lock nut (4) and tighten until it is firm not overtight.
9. Replace Dress Ring (3) and hand tighten.
10. Replace Handle and tighten grub screw (2) then push the blue/red indicator (1) back into the hole.

Now you have finished. Turn back on the water supply and observe for any leaking.

Water pressure must not exceed 500kpa or warranty is void.